



# SDHW1532



33.75" x 14.75" x 18" (H x W x D)

15" wide shallow depth built-in undercounter wine cellar with glass door, stainless steel interior, black cabinet, lock, and digital controls

### Highlights:

Unique 18" shallow depth for an easy fit in kitchen islands

Just under 15" wide for an easy fit, with a flush back design to save space

Commercially listed to NSF-7 standards

### Product Features:

15" Wide Wine Cellar	Single zone wine cooler for residential or commercial storage
18" Depth	Unique 18" shallow depth is ideal for wet bars, island kitchens, and other undercounter areas with limited footprint space
Built-in capable	Front-breathing design lets you make the best use of space by installing your appliance under the counter
Commercially approved	ETL-S listed to NSF-7 Standards and meets UL-471 for use in commercial establishments
Double pane tempered glass door	Elegant design offers a clear but protected view of your interior
Seamless stainless steel door trim	Glass is framed by with a flush one-piece stainless steel trim for an elevated look
Fully articulating European style hinge	Smoother opening and a better fit with an integrated European hinge
Factory installed lock	Keyed lock for a secure interior (2 keys included)
Professional handle	Stainless steel handle completes the look



## SDHW1532 Specifications:

Overview	
Height of Cabinet	33.75" (86 cm)
Width	14.75" (37 cm)
Depth	18.0" (46 cm)
Depth with Handle	19.75" (50 cm)
Depth with door at 90°	32.63" (83 cm)
Capacity	1.8 cu.ft. (51 L)
Bottles	18 bottles
Defrost Type	Frost-Free
Door	Glass
Cabinet	Black
US Electrical Safety	ETL
Canadian Electrical Safety	ETL-C
Sanitation	ETL-S
Amps	1.0
Voltage/Frequency	115 V AC/60 Hz
Weight	88.0 lbs. (40 kg)
Parts & Labor Warranty	1 Year
Compressor Warranty	5 Years
UPC	761101106335
Wine Cellar	
Number of Zones	1
Door Swing	RHD
Reversible	Yes
Adjustable Shelves	Yes
Shelf Type	Steel
Shelf Qty	6
Thermostat Type	Digital
Interior Light	Yes
Fan Type	Interior and Exterior
Refrigerant Type	R600a
Refrigerant Amount	0.64 oz.
High Side PSI	270.0
Low Side PSI	105.0
Interior Height 1	26.0" (66 cm)
Interior Width 1	10.63" (27 cm)
Interior Depth 1	12.25" (31 cm)
Compressor Step Height	3.75" (10 cm)

Compressor Step Width	10.63" (27 cm)
Compressor Step Depth	5.0" (13 cm)
Temperature Range	41°F to 68°F
Sabbath Mode	Yes
Sound Level	33.3 dB

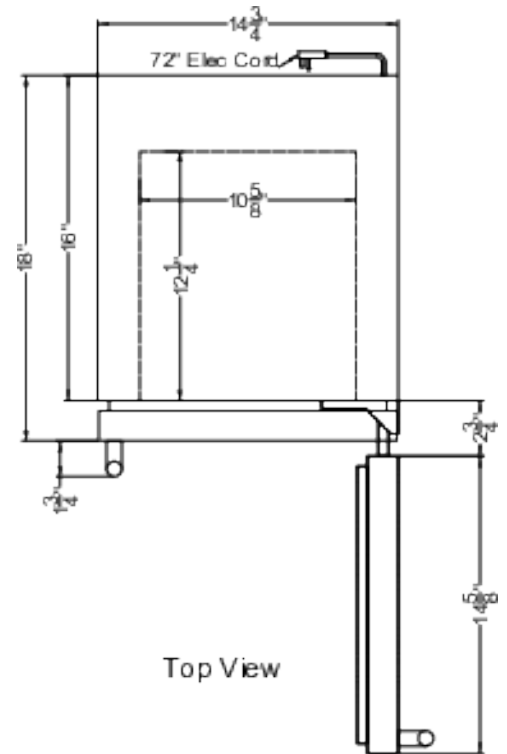

Top View

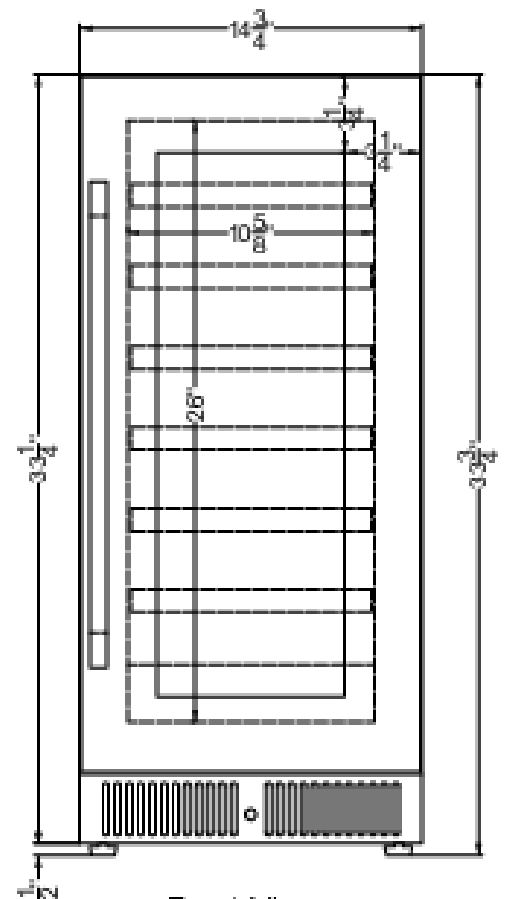

Front View