



Instructions for Installing a Panel on your PNR Model

Models: SCR2466PNR, SWC532LBISTPNR

Your product is designed to accept custom overlay panels on the door frame.

Parts included in PNR kit:

- (8) Screws to attach the custom panel
- (1) Replacement top hinge
- (1) Replacement bottom hinge
- (1) Plastic bushing for the top door hinge

Exterior panel size: 29 $\frac{7}{8}$ " H x 23 $\frac{3}{8}$ " W

Interior panel: 1 $\frac{3}{4}$ " H x 1 $\frac{3}{4}$ " W

Overlay panel can be up to $\frac{3}{4}$ " thick

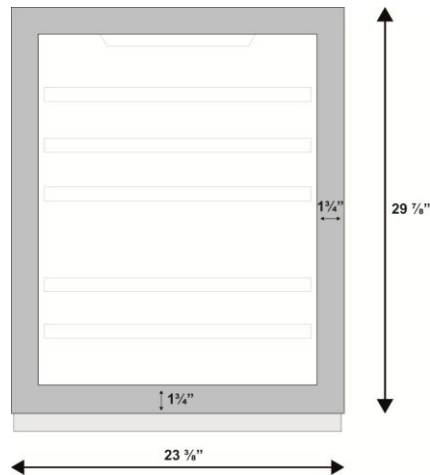

Remove the door from the unit

1. Remove the door from its chassis by unscrewing the top and bottom hinges from the cabinet and door. Save all of the screws for Step 10.
2. Remove the hinge bracket underneath the door. You can discard the hinge, but must save the bottom hinge bracket, as you will reuse it to reattach the door in Step 10.

Attach the handle & panel

3. Attach your door handle to the panel using countersunk screws (not included). You can use the handle that ships with this appliance or substitute your own.
4. Pull out the rubber gasket located around the inner door frame to access the eight screw holes from the inside of the door.
5. Place your custom panel over the door pane.
6. Using the provided screws, attach the panel by holding it in place from the front and screwing it onto the door pane from the inside of the door.
7. Reinstall the gasket to its original position.

Reattach the door

8. You will have to drill a hole into the top and bottom of the custom panel in order to connect it to the new provided hinge. To do this, line the door up in its final position, using the new hinges as a guide to mark where you will be drilling the holes. Drill a hole through the top and bottom of the custom panel using a $\frac{1}{2}$ " drill bit.
9. Insert the provided bushing into the top hole.
10. You can now reinstall the door. Use the replacement bottom hinge and original bottom hinge bracket to reattach the door to the bottom of the cabinet, and the replacement top hinge to reattach to the top of the bushing.